

NP1/NP2

RECTANGULAR AIR VENTS



Description:

Rectangular air vents with a telescopic cuff for installation in a building partition with a thickness of 300–540 mm.



Intended use

The rectangular NP1 and NP2 air vents are designed to supply fresh air to residential, storage or technical rooms such as boiler rooms.

Design

The NP1 and NP2 versions have a slot damper installed inside, used to regulate the air flow through the ventilator. The external intake vent is equipped with a protective mesh and a rain hood. The air intake and the diffuser are connected by a telescopic cuff adapted for mounting the set in a building partition with a thickness of 300 to 550 mm. There is an air filter and an acoustic silencer inside the telescopic cuff. The NP1s and NP2s are available in several variants:

- **OC/ML** – Intake and duct are made of galvanized steel, diffuser painted in white,
- **CC/ML** – Stainless steel air intake (grade. 1.4301), galvanized steel duct, diffuser painted white,
- **ML/ML** – Air intake and diffuser painted white, galvanized steel duct,
- **CH** – Air intake, diffuser and channel made of stainless steel (grade 1.4301).

Operating principle

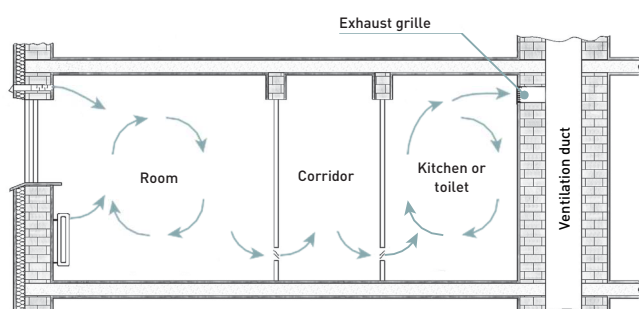

Figure 1. Air flow inside the apartment after installing the air vent in the room and the ventilation grille in the kitchen.

Dimensions

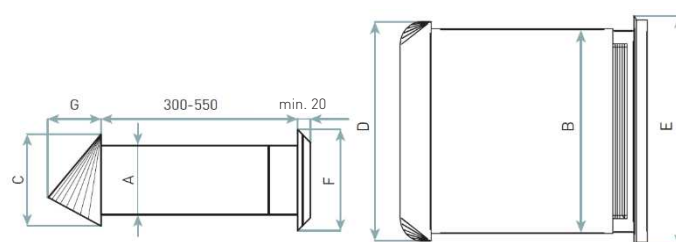

Figure 2. Dimensions of the NP1/NP2 air vent.

Table 1. Dimensions of the NP1/NP2 air vent.

Air vent type	Channel dimensions A × B [mm]	Channel length L [mm]
NP1	53×304	L=300–540
NP2	75×595	L=300–540

Table 2. Dimensions of the NP1/NP2 air vent.

Type	Dimensions [mm]							Channel cross-section [cm ²]	Drag coefficient ζ without filter	Drag coefficient ζ with filter	Weight [kg]
	A	B	C	D	E	F	G				
NP1	53	304	77	326	343	94	47	125	6.3	17.3	2.80
NP2	75	595	99	618	635	116	99	324	7.0	14.5	6.20

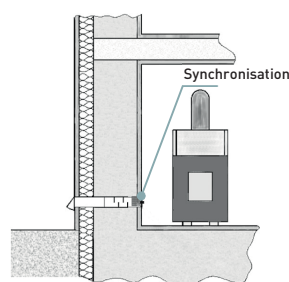

Figure 3. NP1-NP2 installed in the outer wall of the boiler room.

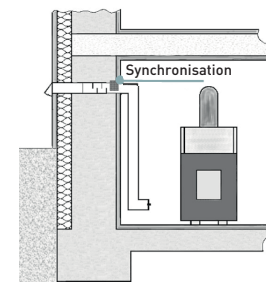

Figure 4. NP1-NP2 with Z-type duct for supplying fresh air to the boiler room in the basement

AIRFLOW CONTROL AND DISTRIBUTION

SO

SN

SL

RAL

Technical data

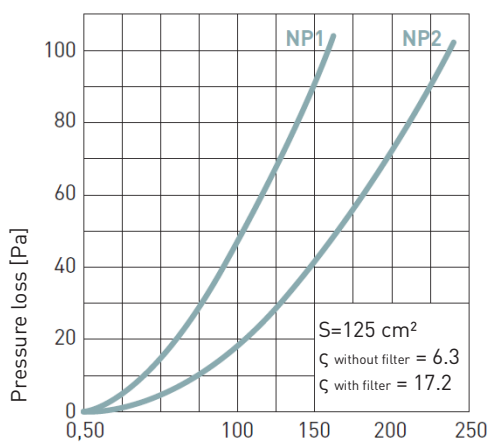

Pressure losses of the rectangular NP1 air vent

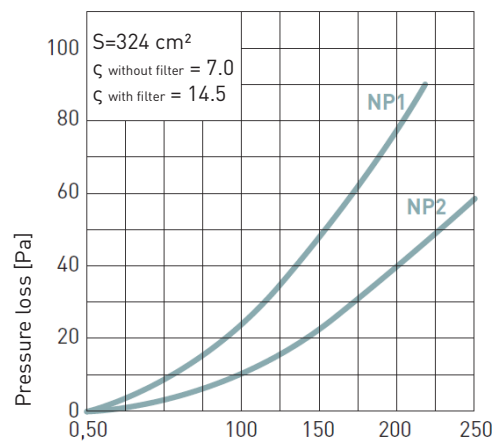

Pressure losses of the rectangular NP2 air vent

NP1 / NP2 – Rectangular air vents

When ordering, please provide information in accordance with the following pattern:

NP<S> - <M>

Where:

S	Ventilation duct size*
	1 – 53 × 304 mm
	2 – 75 × 595 mm
M	Design*
	OC/ML – Air intake and duct made of galvanized sheet metal, white diffuser
	CC/ML – Stainless steel air intake (grade. 1.4301), galvanized steel duct, diffuser painted white.
	ML/ML – Air intake and diffuser painted white, duct made of galvanized steel
	CH – Air intake, diffuser and duct made of stainless steel (grade 1.4301)

* Optional values – if not specified, default values will be used

Sample order: **NP1-CC/ML**



Approval documents available on the website www.smay.pl.